

REV.	AMENDMENT:	DATE:
-	PRODUCTION OF DRAWINGS	xx.xx.xx
A	PLANNING DRAWINGS	05.12.16
B	REVISED PLANNING DRAWINGS	17.03.17

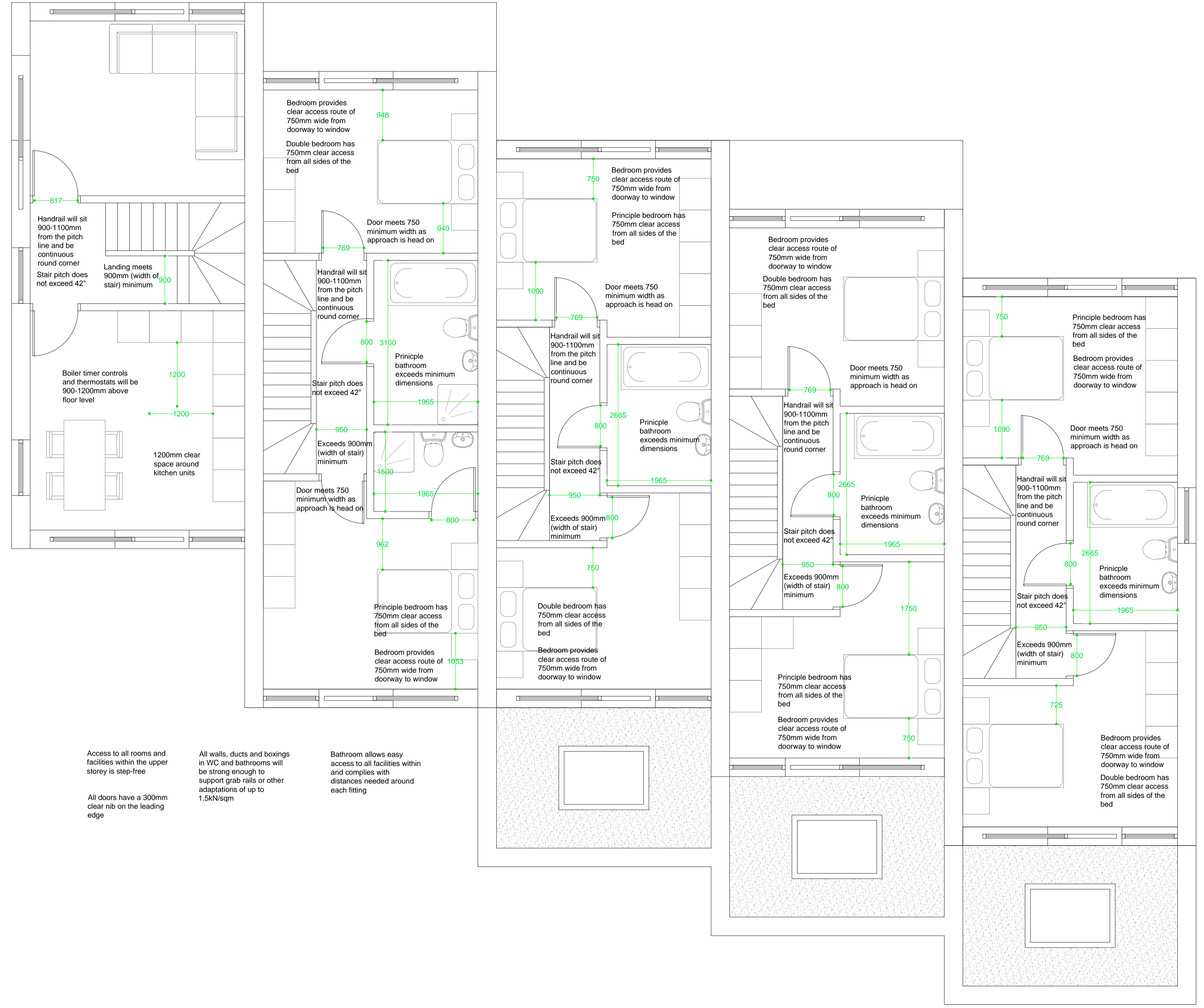

Access to all rooms and facilities within the upper storey is step-free

All walls, ducts and boxings in WC and bathrooms will be strong enough to support grab rails or other adaptations of up to 1.5kN/mqm

Bathroom allows easy access to all facilities within and complies with distances needed around each fitting

All doors have a 300mm clear rib on the leading edge

Proposed First Floor Plan - Part M Compliance 1:50

Proposed First Floor Plan - 1:50

**STATUS: AWAITING APPROVAL**

PROJECT STAGE: S1 - Preliminary

CLIENT: Estuary Cars

PROJECT: Estuary Cars

PROJECT NO: 347-11-15

DRAWING: Proposed - Part M compliance plan

SCALE: 1:50 on A1

DRAWN BY: ABG

CHKD BY: [ ]

Postcode: SS9 9HZ

PAGE NO: P08

REVISION: B

**BUILDER INFORMATION:**  
DO NOT BUILD FROM ANY DRAWINGS PACKAGES THAT DO NOT SAY 'BUILDING CONTROL APPROVED OR IN CONSTRUCTION PACKAGES'. IT IS THE RESPONSIBILITY OF THE BUILDER TO CONTACT THE ARCHITECT TO REQUEST/CONFIRM THE RIGHT DRAWING PACKAGE IS ON SITE. PLEASE BE ADVISED THAT ALL DRAWING PACKAGES WILL ALSO HAVE STRUCTURAL ENGINEERING WORKS ATTACHED. DO NOT BUILD WITHOUT ALL PAPERWORK.

**DRAWING NOTES:**  
ALL ITEMS, NOTES, DIMENSIONS AND GENERAL DESIGN CONTAINED IN THIS DRAWING ARE FOR GUIDANCE PURPOSES ONLY. NOMINATED BUILDER AND PERSON RESPONSIBLE FOR THE PROJECT SHOULD MAKE A THOROUGH CHECK PRIOR TO COMMENCEMENT OF WORKS AGAINST SITE, DRAINAGE SERVICE DRAWINGS, CURRENT BUILDING REGULATIONS, BRITISH STANDARDS AND CODES OF PRACTICE. FAILURE TO DO SO WILL BE AT THE LIABILITY OF THE BUILDER/CONTRACTOR NOT THE ARCHITECT.

THE CONTRACTOR IS TO ALLOW WITHIN THEIR PRICE FOR ALL ITEMS NOT LISTED BUT THAT WILL BE REQUIRED TO COMPLETE THE WORK IN ACCORDANCE WITH ALL CURRENT LEGISLATION.